



## 15" Ceramic Subwoofer

|                     |              |
|---------------------|--------------|
| Program Power       | 7000 W       |
| Rated impedance     | 1+1 Ohm      |
| Nominal diameter    | 15" - 380 mm |
| Sensitivity (1W/1m) | 96 dB        |
| Voice coil diameter | 3 in - 75 mm |
| Frequency Range     | 25-200 Hz    |

### SPECIFICATIONS

|                                     |   |
|-------------------------------------|---|
| Nominal Diameter                    | 15" - 380 mm                                  |
| Rated Impedance                     | 1+1 Ohm                                       |
| Nominal Power Handling <sup>1</sup> | 700+700 W                                     |
| Program Power <sup>2</sup>          | 7000 W  |
| Sensitivity <sup>3</sup>            | 96 dB   |
| Frequency Range <sup>4</sup>        | 25-200 Hz                                     |
| Minimum Impedance                   | -   |
| Basket Material                     | Aluminum                                      |
| Magnet Material                     | Ferrite                                       |
| Cone Material                       | Reinforced cellulose fiber                    |
| Cone Shape                          | Straight                                      |
| Surround                            | Polyurethane                                  |
| Suspension                          | Nomex Fabric                                  |
| Voice Coil Diameter                 | 3 in - 75 mm                                  |
| Voice Coil Winding Material         | Flat aluminium                                |
| Voice Coil Length                   | 51 mm - 2,01 in                               |
| Voice Coil Former Material          | Aluminum                                      |
| Connection type                     | Screw terminal                                |
| Ferrofluid                          | No  |
| Magnetic Gap Height                 | 15 mm - 0,59 in                               |
| Max. Peak to Peak Excursion         | -   |
| Efficiency Bandwidth Product EBP    | 91  |
| Recommended Loading                 | Vented Box                                    |
| Volume / Tuning frequency           | 75 Lt (dm <sup>3</sup> ) - 2,649 cuft / 39 Hz |
| Maximum recommended frequency       | -   |
| Alternative Available Version       | 2+2 Ohm CSW7015EVO                            |

### T/S PARAMETERS

1+1 Ohm

\* Parameters measured with voice coils connected in series

|                                    |      |                                      |
|------------------------------------|------|--------------------------------------|
| Resonance frequency                | Fs   | 42 Hz                                |
| DC Resistance                      | Re   | 1,8 Ohm                              |
| Mechanical Q Factor                | Qms  | 7,7                                  |
| Electrical Q Factor                | Qes  | 0,46                                 |
| Total Q Factor                     | Qts  | 0,44                                 |
| BI Factor                          | Bl   | 20,1 Tm                              |
| Effective Moving Mass              | Mms  | 399 g                                |
| Equivalent Gas air loaded          | Vas  | 36 lt (dm <sup>3</sup> ) - 1,27 cuft |
| Suspension Compliance              | Cms  | -                                    |
| Effective Piston Diameter          | D    | 325 mm - 12,8 in                     |
| Effective piston area              | Sd   | 830 cm <sup>2</sup> - 128,65 sq in   |
| Max. Linear Excursion <sup>5</sup> | Xmax | 22 mm - 0,87 in                      |
| Voice Coil Inductance @ 1kHz       | Le   | 1,18 mH                              |
| Half-space Efficiency              | η0   | 0,55 %                               |

### NOTES

<sup>1</sup> Nominal power is determined according to AES2-1984 (r2003) standard.

<sup>2</sup> Program Power is defined as 3 dB greater than the Nominal rating.

<sup>3</sup> Sensitivity represents the averaged value of acoustic output as measured on the forward central axis of cone, at distance 1m, when connected to 2,83V sine wave test signal.

<sup>4</sup> Frequency range is given as the band of frequencies delineated by the lower and upper limits where the output level drops by 10 dB below the rated sensitivity in half space environment.

<sup>5</sup> Linear Math. Xmax is calculated as  $(Hvc-Hg)/2 + Hg/4$  where Hvc is the coil depth and Hg is the gapdepth.

<sup>6</sup> Frequency response curve is measured in box.

<sup>7</sup> Impedance curve is measured in free air conditions at small signals.

### FREQUENCY RESPONSE AND IMPEDANCE CURVE <sup>6 7</sup>

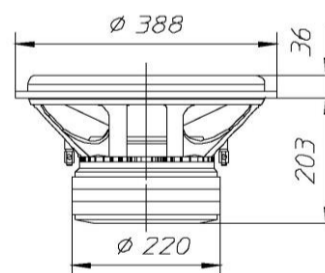
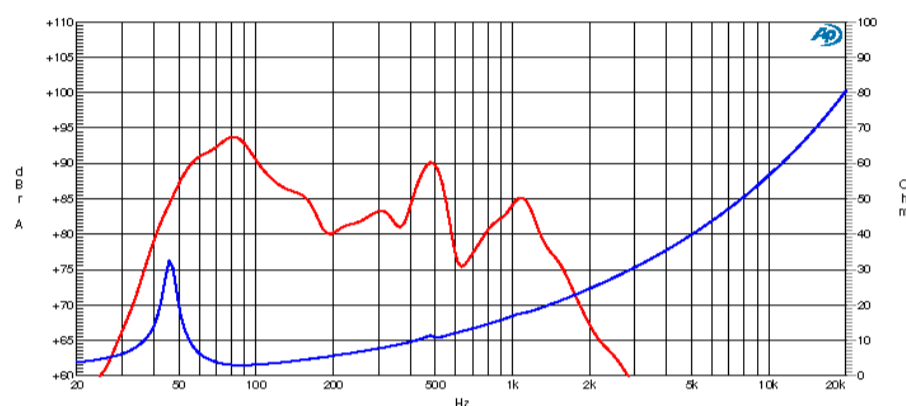

### MOUNTING AND SHIPPING INFORMATION

|                                  |                    |
|----------------------------------|--------------------|
| Overall Diameter                 | 388 mm - 15,28 in  |
| Baffle Cutout Diameter           | 350 mm - 13,78 in  |
| Flange and Gasket Thickness      | 36 mm - 1,42 in    |
| Total Depth                      | 239 mm - 9,41 in   |
| Bolt Circle Diameter             | 368 mm - 14,49 in  |
| Bolt Holes Quantity and Diameter | 8 / 7 mm - 0,28 in |
| Net Weight                       | 19,6 Kg - 43,17 lb |
| Shipping Units                   | 1 Pc               |